

FlowMatic® 08

GROSS WEIGHT - COMMERCIAL WEIGHING



FlowMatic® 08

Rate: 20 to 40 big bags/hr.
Weight capacity: 2 tons/big bag
Objectives: big bag with single handle & loading from the bulk products storage

TECHNICAL SPECIFICATIONS

Flow rate: 20 to 40 big bags/hr.
Manufacturing materials: mild steel, SS 304L, SS 316L
Finishes: RAL 9006, micro-blasted, electropolishing
Installed power: 5.6 kW
Average power consumption : 0.3 kW
Service pressure: 6 bars
Input 4 - 20 mA: 1
Input TOR: 7
Output TOR: 3
Weighing precision: ± 500 grams
Dust collecting rate: 300 m³/hr.
Maximum dimensions of big bags:
Length x width x height: 1,300 x 1,300 x 2,400 mm



PACKAGING UNIT FOR SINGLE HANDLE BIG BAG WITH TELESCOPIC FILLING TUBE

PALAMATIC PROCESS has designed a complete range of big bag filling stations to meet diverse needs of the industries. The FlowMatic® 08 model is an efficient and flexible solution for a simple conditioning of bulk materials with important tonnage, mainly dedicated to quarries, grain or fertilizer industries.



Commercial weighing



Loading from the storage of bulk materials area

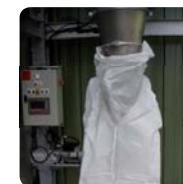

The fan inflates and shapes the big bag



Holding hook for big bag and feeding tube

Advantages

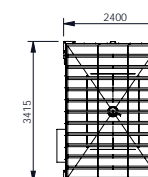
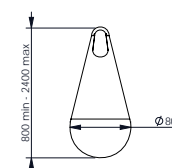
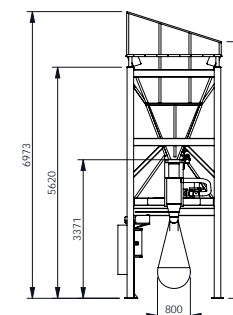
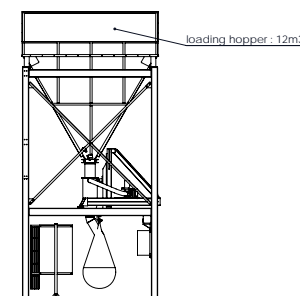

Options



Big bag pre-forming fan



Belt conveyor