

▶ ADVANTAGES

- Easy setup
- Operating pressure from 2 to 6 bar
- Reduced air consumption
- Unique high-efficiency design
- Full range of products
- Renewed design



▶ APPLICATIONS

The air cannon is used to avoid the emergence of bridges or stacks. It is ideal for setting in motion dry bulk solids and light irregular shapes (fibers, chips, flakes, wood chips, plastic chips).

▶ TECHNICAL SPECIFICATIONS

The air cannons are designed to inject high pressure gas (air or nitrogen) jets of up to 6 bar (87 PSI) for a short time (usually fractions of a second), resulting in the collapse of bridges and stacks.

In a standard version, the air cannons are activated in electropneumatic way. A fully pneumatic version is available on request.

When using multiple air cannons, those below must be operated first; it must then go gradually up at regular intervals. The curved discharge pipe carries air tangentially along the wall or bottom of the silo (zero impact on the bottom of the silo or structure).

The robust design allows installing the air cannons outdoor.

The external parts of the body are made of aluminum and galvanized steel.

They are provided with a mounting plate to be welded to the wall of the hopper or silo and a safety system to prevent accidental slip during installation or maintenance.

The air cannons are available in 3 sizes.

▶ DIMENSIONS IN MM

| Type | a | b | c |
|-------|-----|-----|-----|
| PG040 | 130 | 220 | 243 |
| PG063 | 160 | 260 | 283 |
| PG080 | 200 | 308 | 336 |

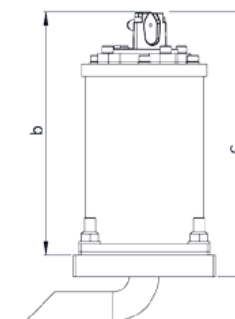

▶ PERFORMANCES

| Type | Air consumption | | Air connection | Kg | Packing dimensions in mm |
|-------|-----------------|-------|----------------|------|--------------------------|
| | 3 bar | 6 bar | | | |
| PG040 | 0.60 | 1.3 | 1/8 pipe 6 mm | 8.2 | 270 x 185 x 170 |
| PG063 | 1.17 | 2.3 | 1/4 pipe 8 mm | 16.2 | 450 x 200 x 220 |
| PG080 | 2.30 | 4.8 | 1/4 pipe 8 mm | 29.7 | 450 x 200 x 220 |

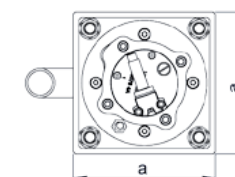

▶ MOUNTING PRINCIPLE

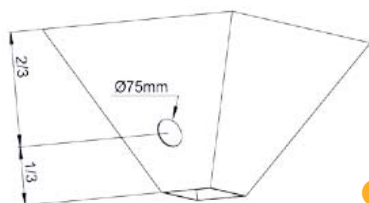
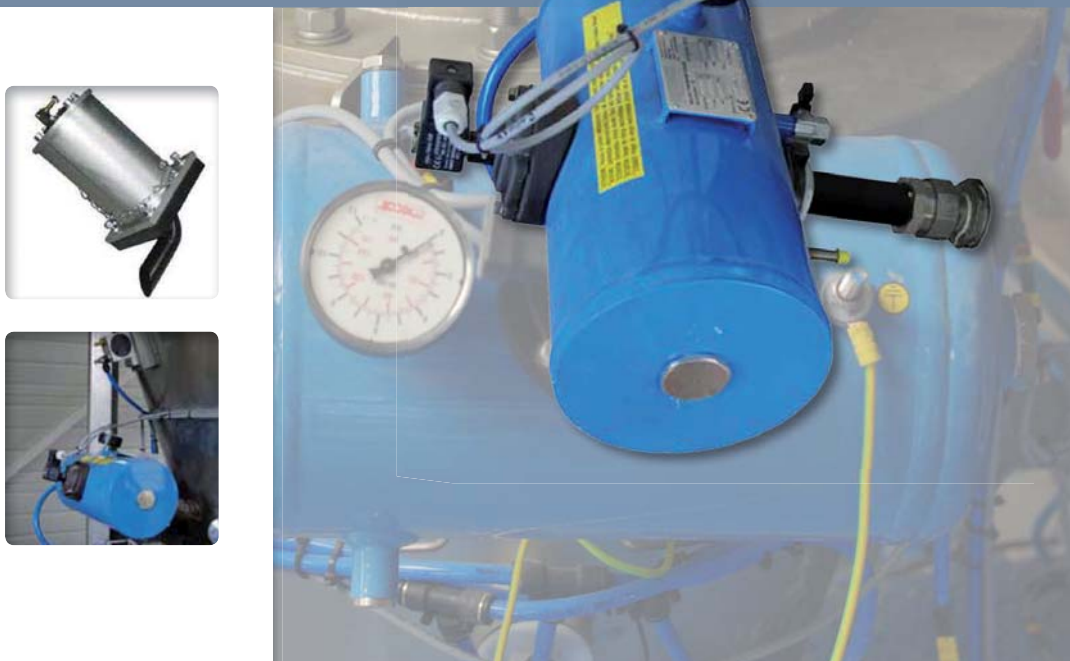

1

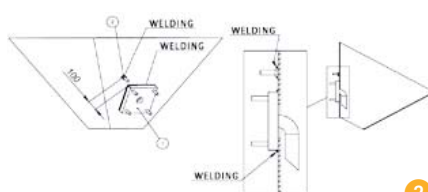

2

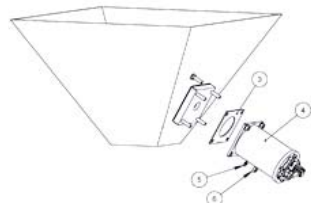

3

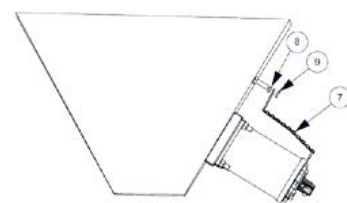

4